

AIRCRAFT PARKING CHART - ICAO (APRON 5)

ARP 35°51'27" N  
14°28'39" E

ELEV 297 feet

TWR 135.1  
GROUND 121.6

MALTA / LUQA

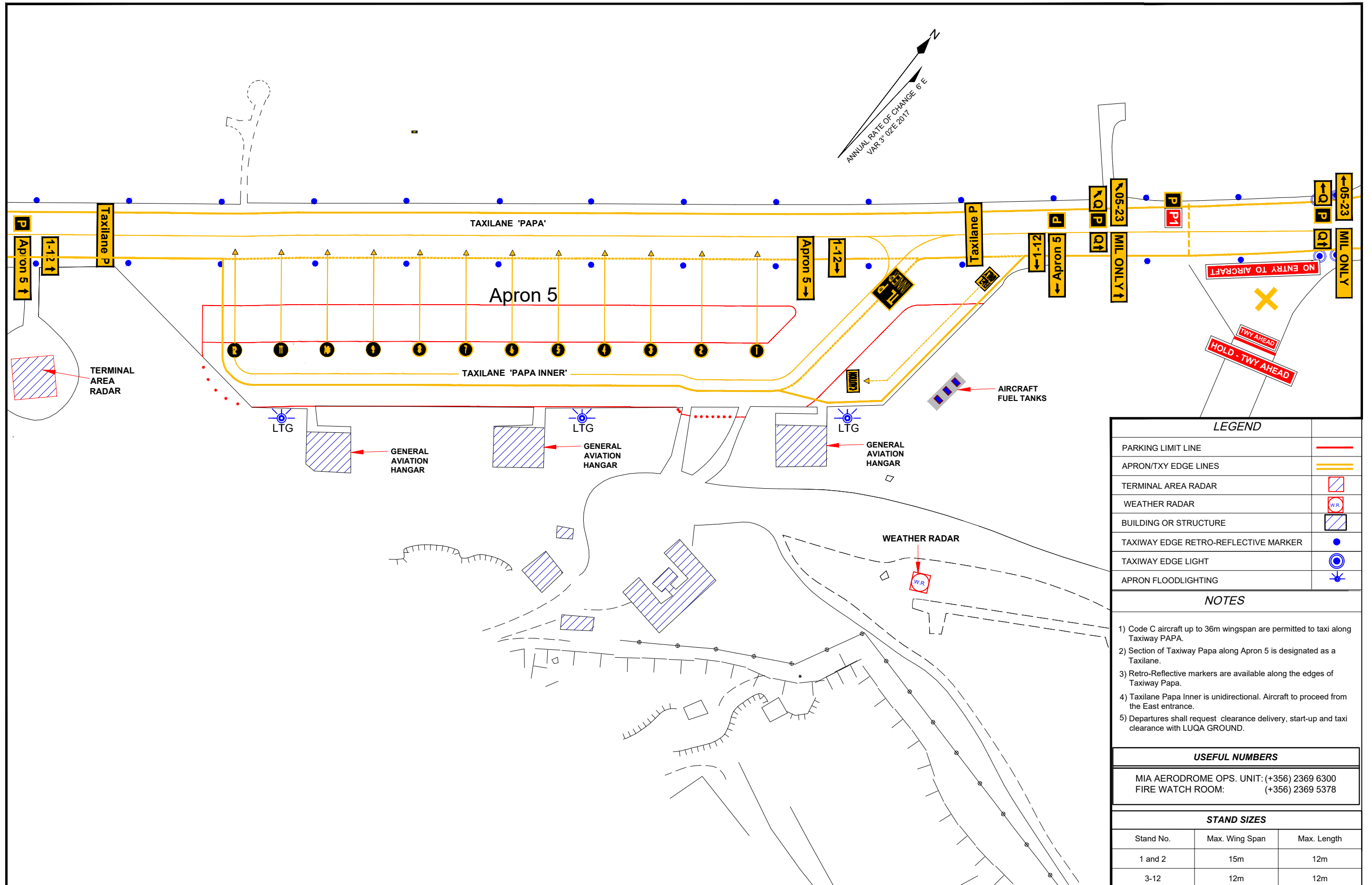

LEGEND	
PARKING LIMIT LINE	—
APRON/TXY EDGE LINES	==
TERMINAL AREA RADAR	▨
WEATHER RADAR	WR
BUILDING OR STRUCTURE	▨
TAXIWAY EDGE RETRO-REFLECTIVE MARKER	●
TAXIWAY EDGE LIGHT	⊙
APRON FLOODLIGHTING	⊙

- NOTES**
- Code C aircraft up to 36m wingspan are permitted to taxi along Taxiway PAPA.
  - Section of Taxiway Papa along Apron 5 is designated as a Taxilane.
  - Retro-Reflective markers are available along the edges of Taxiway Papa.
  - Taxilane Papa Inner is unidirectional. Aircraft to proceed from the East entrance.
  - Departures shall request clearance delivery, start-up and taxi clearance with LUQA GROUND.

USEFUL NUMBERS	
MIA AERODROME OPS. UNIT:	(+356) 2369 6300
FIRE WATCH ROOM:	(+356) 2369 5378

STAND SIZES		
Stand No.	Max. Wing Span	Max. Length
1 and 2	15m	12m
3-12	12m	12m